

KU
BE

SAINT • TROPEZ

WELLNESS ▪ POOL ▪ ROOFTOP

WHERE VIBRANCY MEETS ENERGY

PART OF
MACHEFERT
GROUP



KUBE SAINT-TROPEZ, THE MUST-VISIT ADDRESS ON THE FRENCH RIVIERA

Just a few steps away from the vibrant Saint-Tropez, the Kube reveals itself as a lively place, established in simple luxury, imbued with generosity and conviviality.

In the heart of two hectares of Mediterranean gardens, the hotel offers a breathtaking view of the Gulf of Saint-Tropez from its rooftop. It's a perfect place to recharge your batteries.

People come here to soak up good vibes,
let go, and reconnect.

70 BEDROOMS	1 RESTAURANT
9 BUILDINGS	1 BAR
2 HECTARES	1 TERRACE WITH VIEW OF THE GULF
1 FITNESS ROOM	1 MEETING ROOM INCLUDING A PRIVATE TERRACE
1 ROOFTOP	



KEY FIGURES

SEMINAR / STUDY DAY / PRIVATE RECEPTION / COCKTAIL PARTY / DINNER / SHOWROOM

	PAX MAXIMUM	SQUARE METER	THEATER	CLASSROOM	U-SHAPE	BANQUET	COCKTAIL
LOBBY BOUTIQUE	40						
ROOFTOP	100						
RESTAURANT - INDOOR	40						
RESTAURANT - OUTDOOR	400						
SEMINAR		100	80	60	40	60	80
SEMINAR TERRACE		50					40
POOL WHITE	100						
POOL WOOD	100						
POOL IBIZA	50						
WHITE GARDEN	500						
WOOD GARDN	100						
RECEPTION GARDEN	150						
CAR PARK	CAN BE PRIVATIZED						

ACCESSIBILITY

AIRPORTS

Nice - 90 min

Toulon - 60 min

La Môle Saint-Tropez - 25 min private jet access

Cannes-Mandelieu - 60 min private jet access

RAILWAY STATIONS

Aix-en-Provence – TGV 90 min

Saint-Raphaël – 40 min

Toulon – 60 min

HELIPADS

La Môle Saint-Tropez - 25 min private jet access

Cannes-Mandelieu - 60 min private jet access

A8 MOTORWAY

Le Muy Exit

SHUTTLE SERVICE

Available every day to Saint-Tropez



A MEETING ROOM
WITH PRIVATE TERRACE



EXCLUSIVE ACCOMMODATION

We offer 4 high-end universes
70 keys within 9 buildings over 2 hectares

Inspired by the Mediterranean,
choose between our suites and with a view over the garden or
the Gulf of Saint-Tropez, your stay promises
to be exhilarating and rejuvenating.

IBIZA

An escape with bohemian chic decor and a singular universe, ideal for getting together with friends or family. Ibiza rooms feature a private terrace with direct access to the resort's most peaceful pool.



WHITE

With their sleek design and clean lines, the White rooms form an intimate cocoon with uninterrupted views of the Mediterranean or the gardens.



NATURAL

Located in the main building, the Natural rooms feature minimalist, uncluttered decor. Solid oak and cashmere fabrics, sisal flooring: the naturalness of the materials blends with the warmth of beige colours bathed in natural light.



WOOD

Warm decor in 5 villas decorated with natural materials, including a private villa facing the sea, with a kitchen, dining room and two lounges.



ROOM CATEGORIES

CATEGORIES	QUANTITY OF ROOMS	VIEW	SURFACE AREA
CLASSIC WHITE	6	swimming pool - pine forest - path	25m ²
CLASSIC WHITE SEA	1	sea - swimming pool	25m ²
DELUXE WHITE	10	swimming pool - pine forest - path	30m ²
DELUWE WHITE SEA	7	sea - swimming pool	30m ²
JUNIOR WHITE	3	swimming pool	40m ²
SUITE WHITE SEA	1	sea - swimming pool	65m ²
CLASSIC NATURAL	2	swimming pool - pine forest - path	25m ²
CLASSIC NATURAL SEA	1	sea - swimming pool	25m ²
PRESTIGE NATURAL	4	swimming pool - pine forest - path	30m ²
PRESTIGE NATURAL SEA	4	sea - swimming pool	30m ²
JUNIOR NATURAL SEA	2	sea - swimming pool	48m ²
DELUXE IBIZA	1	swimming pool	35m ²
JUNIOR IBIZA	1	swimming pool	60m ²
DELUXE WOOD	24	garden - swimming pool	30m ²
DELUXE WOOD SEA	2	sea - swimming pool	30m ²
SUITE WOOD	1	sea - swimming pool	120m ²
TOTAL	70 ROOMS		

RESTAURANT & BAR

Kube offers a generous and creative Mediterranean-inspired menu, tailored to each space: the restaurant, rooftop, pools, room service, and breakfast.

Sunny flavors, reinvented classics, and subtle touches of Asian influence.

Please note that we can adapt our menu for your event





THE ROOFTOP

Sunlit by day, glowing by night,
the rooftop at Kube Saint-Tropez offers an open-air spectacle
with every sunset.

THE TERRACE OVER THE GULF

Our titanic terrace hosts breakfasts, lunches and dinners with a rare and breathtaking view of the Gulf.





3 SWIMMING POOLS

Two are heated

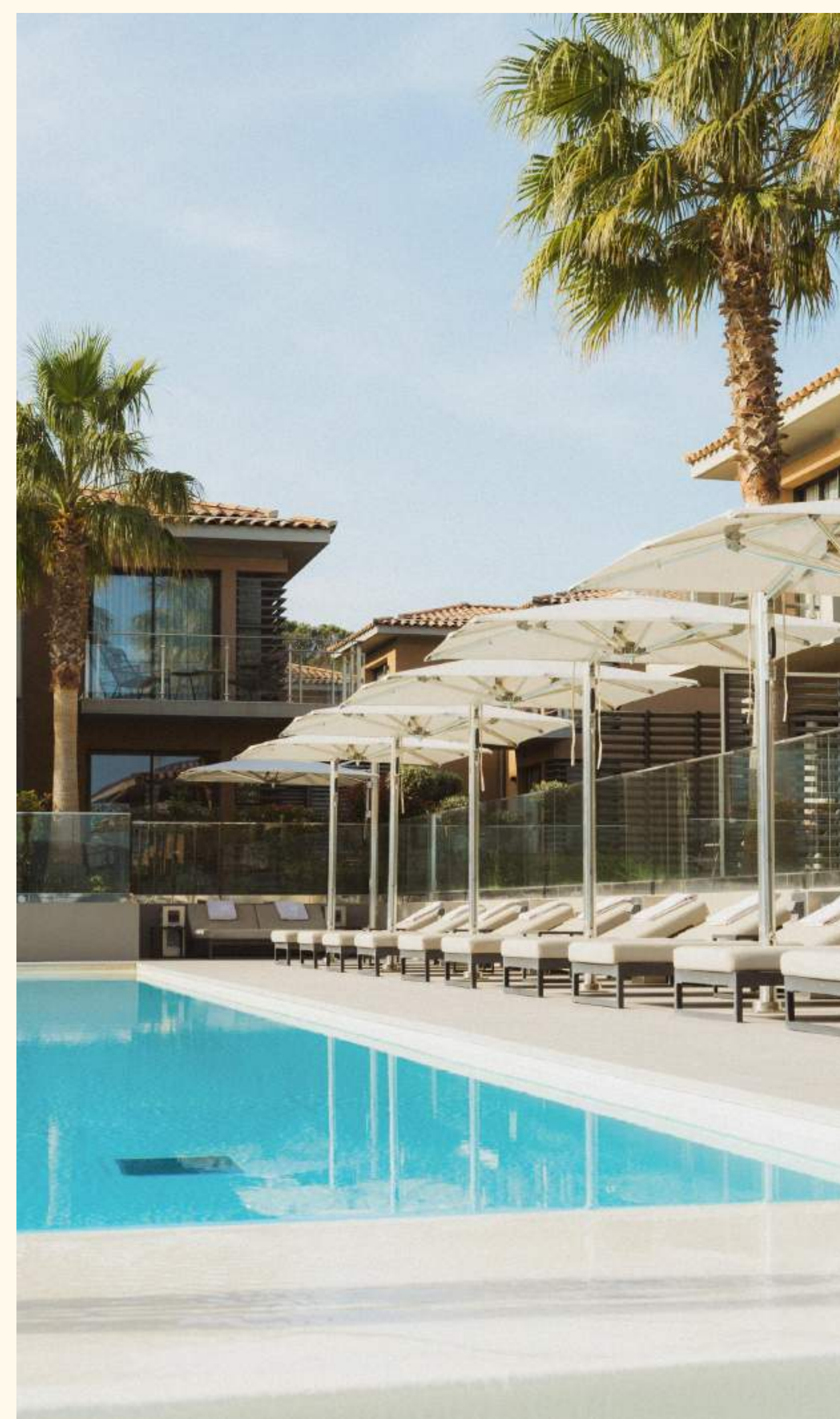



ENERGIZING WELLNESS

Kube Saint-Tropez promises an atmosphere
where you can relax and regenerate.

A place of well-being filled with positive energy,
offering a holistic approach that reconciles body and soul.

HAMMAM & SAUNA

The Spa at Kube Saint-Tropez spans 300m² over two levels, featuring six treatment rooms, including one double suite, a hammam, and a sauna.

Designed to offer a holistic approach to beauty and wellness, the spa provides a tailored, personalized experience for each guest. In partnership with myBlend, we offer exclusive treatments that combine dermatological expertise and customization to enhance your skin and reveal your natural glow.

myBlend TREATMENTS

BEAUTY SALON

SPORT



LET'S TALK ABOUT YOUR EVENT

Set across 2 hectares, our 70-room resort offers an ideal setting for all your events, whether private or professional.

A rooftop with breathtaking 360° sea views, a meeting room with a terrace, outdoor spaces, three swimming pools, a restaurant, underground parking... The venue can be fully or partially privatized, with tailored support from an experienced and dedicated team.



VIP Shuttle (DBX)
Suite Signature Aston Martin



CORPORATE EVENTS

PORSCHE

75th anniversary



ATHINA
ONASSIS
HORSE SHOW
LONGINES

3 years of partnership
Riders accomodation & brand visibility

PRIVATE EVENTS

3 SPACES, 3 AMBIANCES

Please note that the furniture and fittings are indicative only. You have the choice of decoration and suppliers



MAIN SWIMMING POOL - VIEW OVE THE GULF - GARDEN PARTY



MAIN SWIMMING POOL - VIEW OVER THE GULF - GARDEN PARTY



MAIN SWIMMING POOL - VIEW OVER THE GULF - GARDEN PARTY

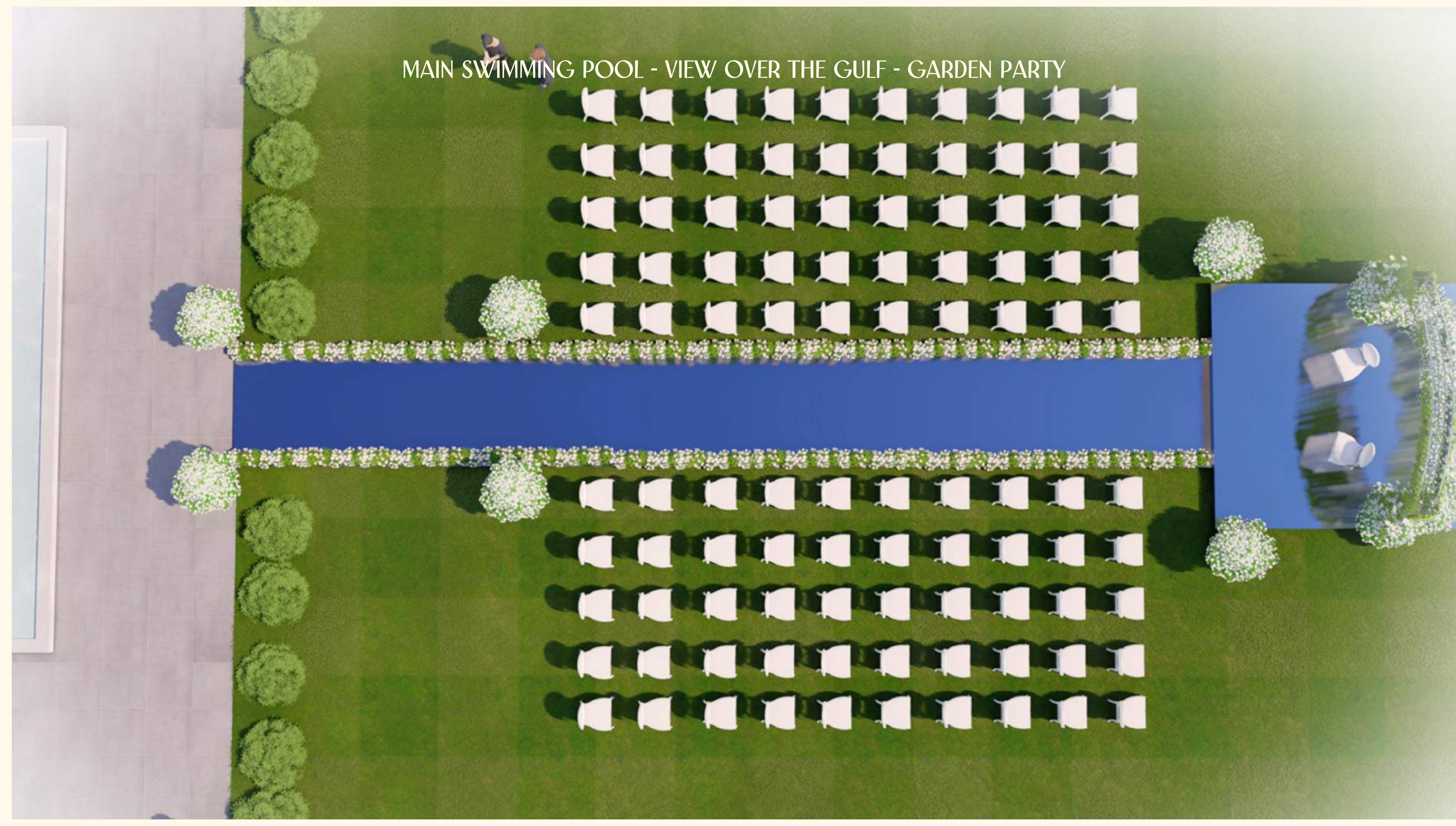

MAIN SWIMMING POOL - VIEW OVER THE GULF - GARDEN PARTY



MAIN SWIMMING POOL - VIEW OVER THE GULF - GARDEN PARTY

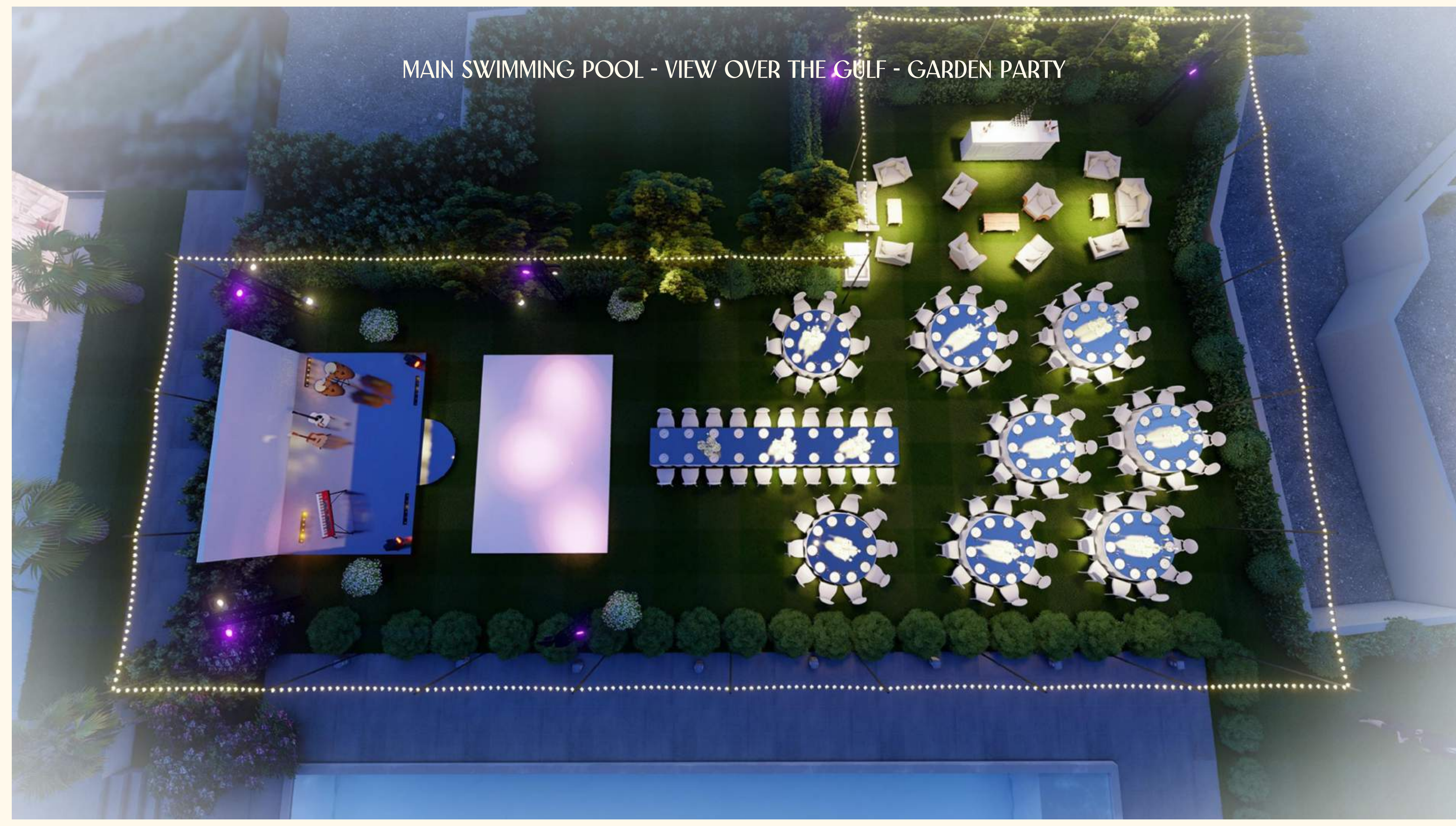

MAIN SWIMMING POOL - VIEW OVER THE GULF - GARDEN PARTY



ROOFTOP - VIEW OVER THE GULF



ROOFTOP - VIEW OVER THE GULF



ROOFTOP - VIEW OVER THE GULF



PRIVATE SWIMMING POOL - VIEW OVER THE GULF

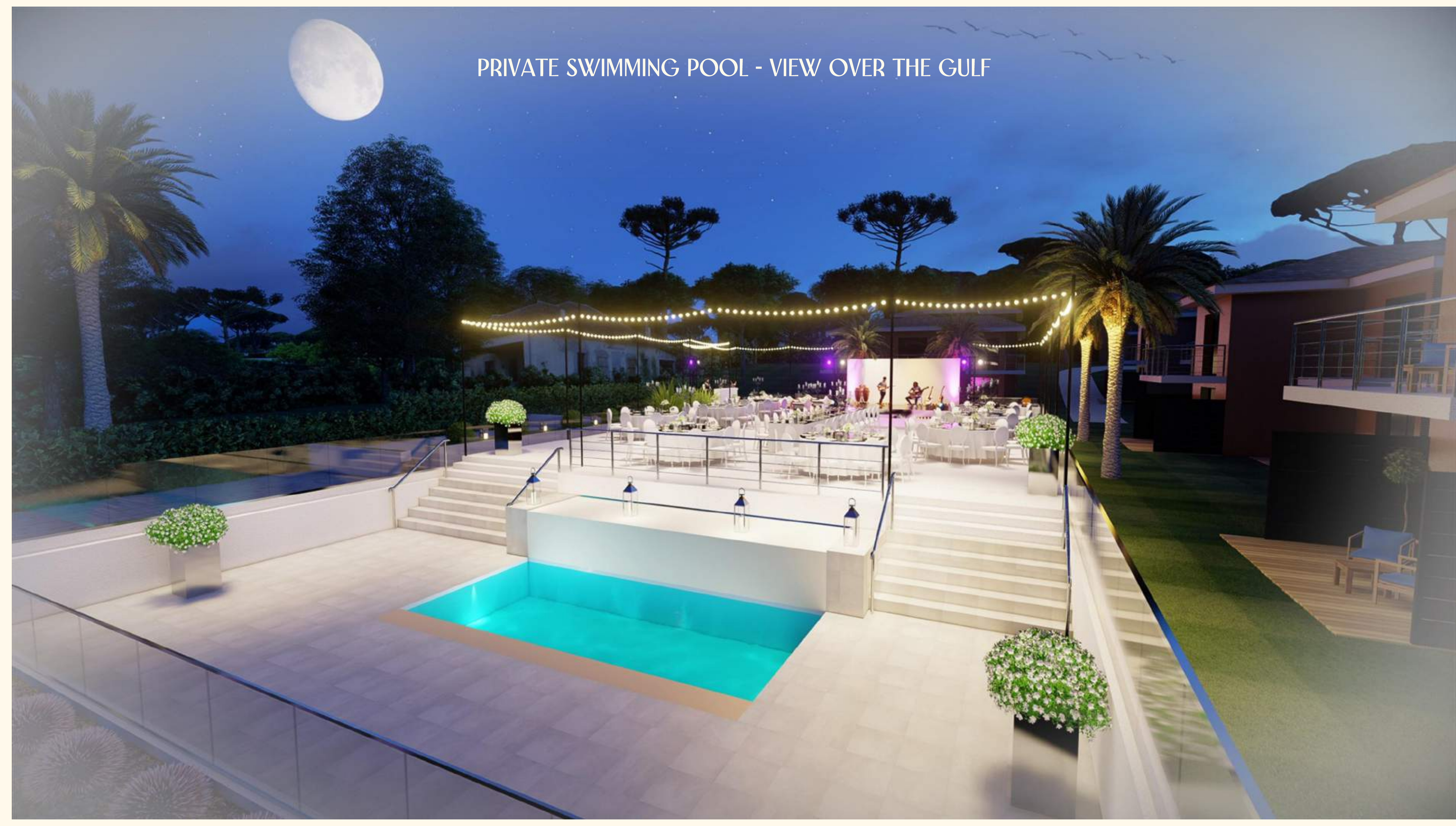

PRIVATE SWIMMING POOL - VIEW OVER THE GULF



PRIVATE SWIMMING POOL - VIEW OVER THE GULF



PRIVATE SWIMMING POOL - VIEW OVER THE GULF





ADDRESS

Kube Saint Tropez
319 route du littoral,
83580 Gassin,
France

CONTACT

Marie Joly

Sales Manager

Kube Saint-Tropez & Cybele Ramatuelle –
Groupe Machefert

mjoly@machefert.com

Tel: 04 94 97 20 00

Mobile: 06 95 70 14 52

@kubesainttropez

www.kubehotel-saint-tropez.com/

PART OF
MACHEFERT
GROUP

